

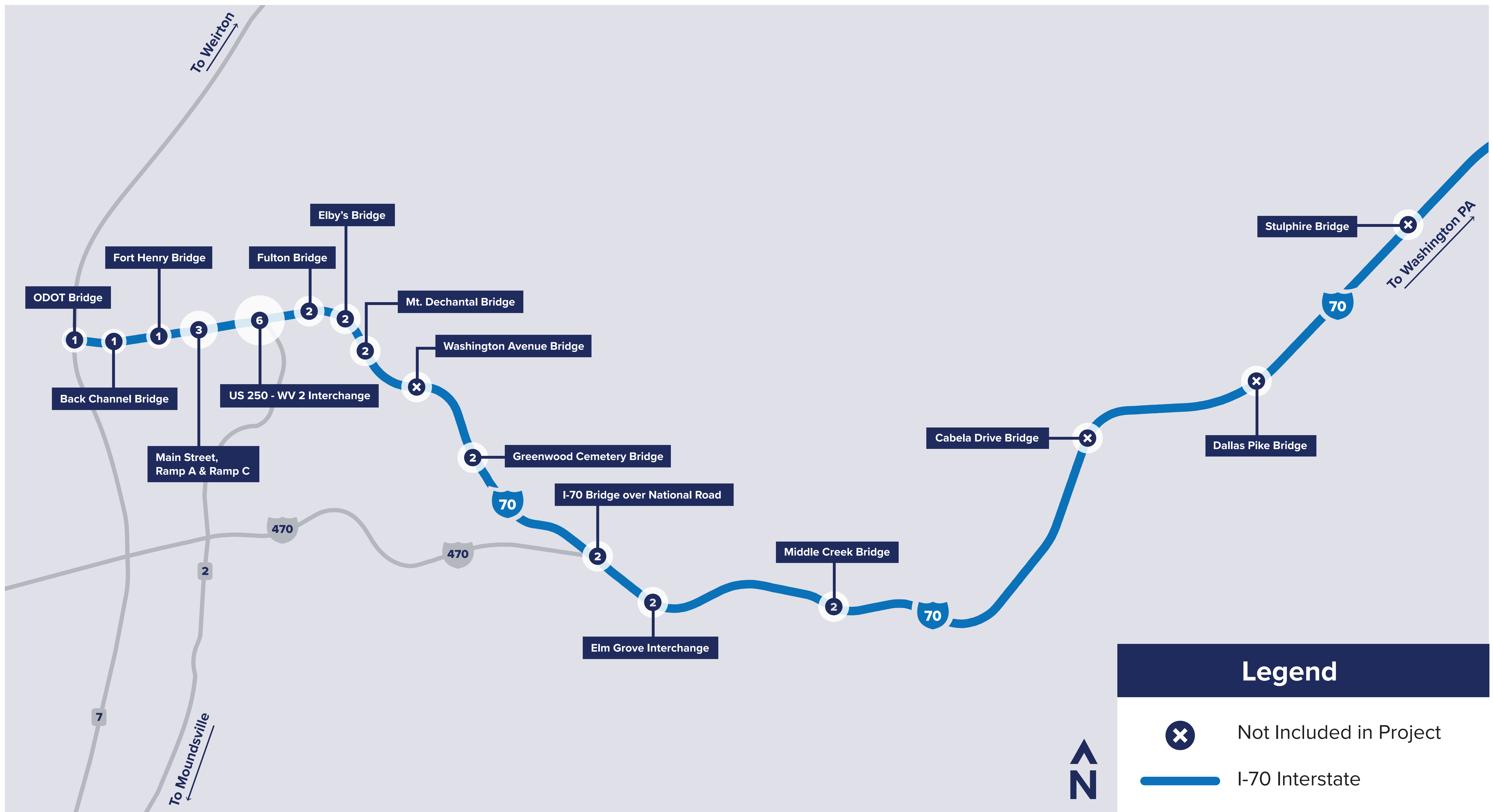

I-70 BRIDGES Project Map

State Project Number
S335-70-0.01 00

Federal Project Number
NFA-2317(008)





I-70 BRIDGES Project Map - A

State Project Number
S335-70-0.01 00

Federal Project Number
NFA-2317(008)



DRIVE
FORWARD
WV
INVESTING IN WEST VIRGINIA'S FUTURE

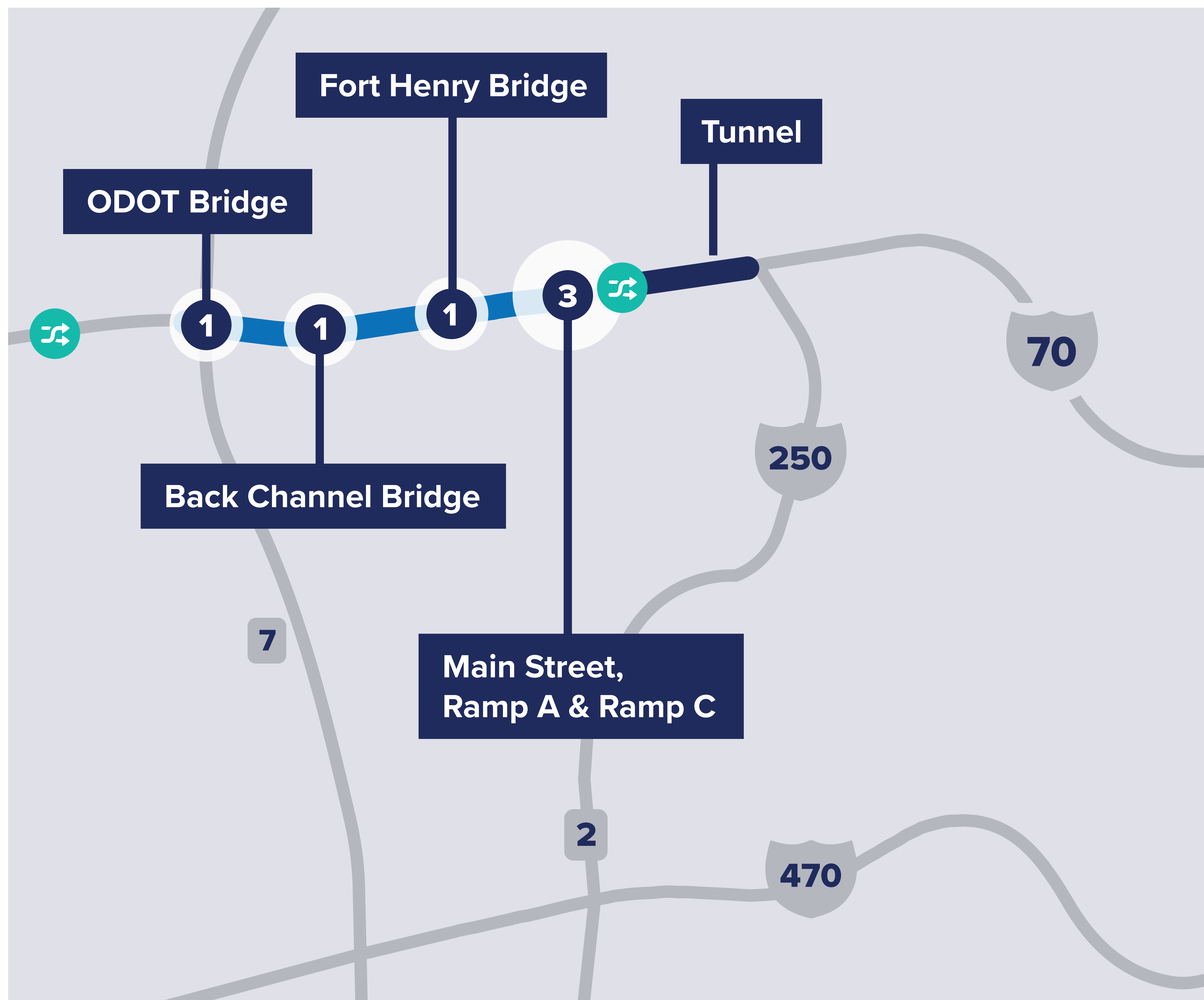

Typical Sections

Phase 1

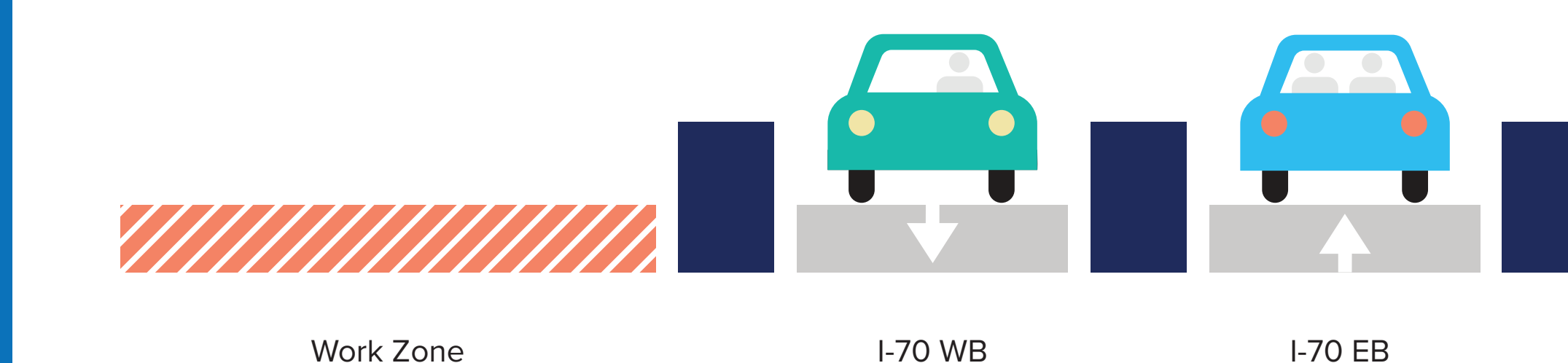

- All traffic on existing I-70 EB lanes
- Maintain one lane in each direction from ODOT Bridge to Wheeling Tunnel
- Some ramps may be closed and detoured

Phase 2

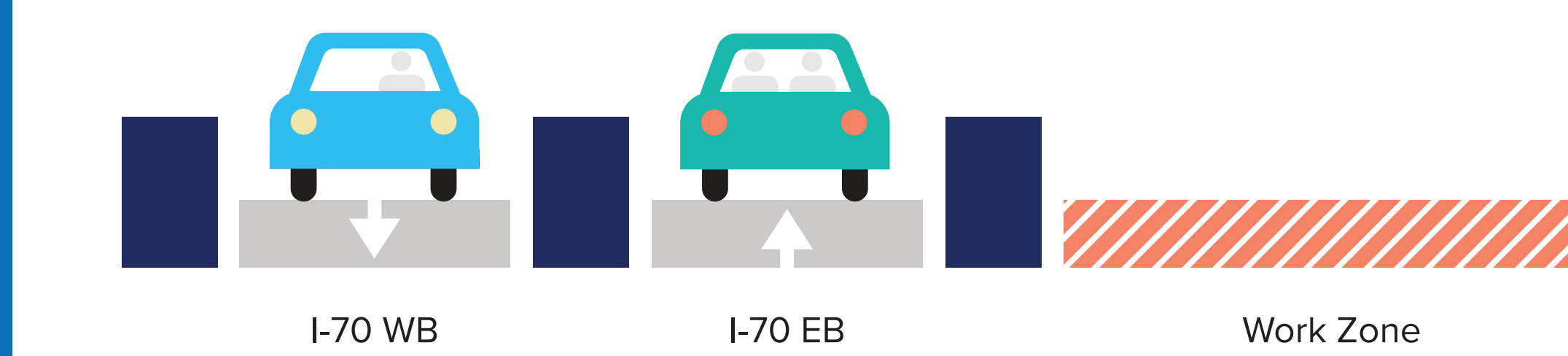

- All traffic on existing I-70 WB lanes
- Maintain one lane in each direction from ODOT Bridge to Wheeling Tunnel
- Some ramps may be closed and detoured

Legend



Crossover



Not Included in Project



I-70 Interstate



I-70 BRIDGES Project Map - B



State Project Number
S335-70-0.01 00

Federal Project Number
NFA-2317(008)

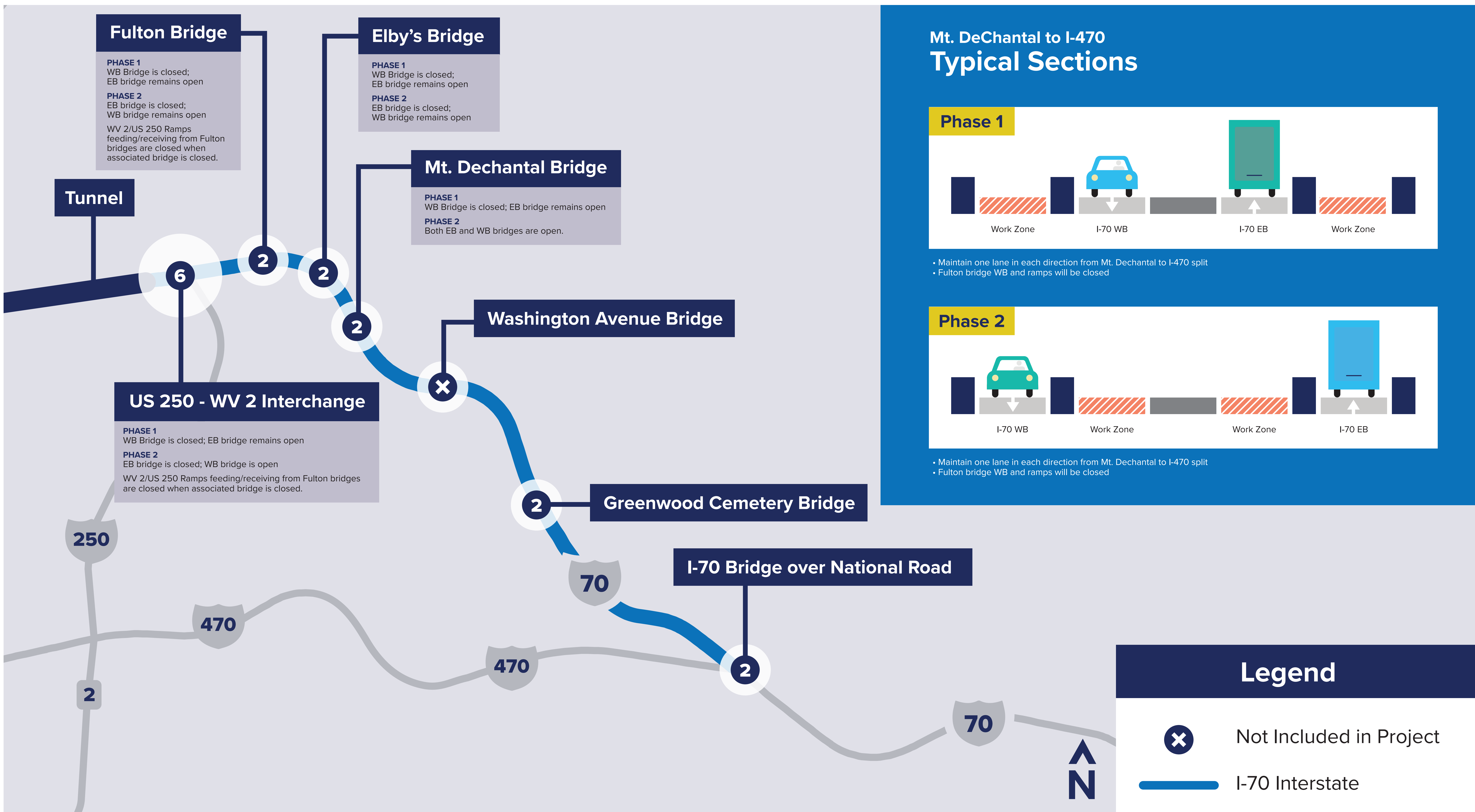



I-70 BRIDGES Project Map - C

State Project Number
S335-70-0.01 00

Federal Project Number
NFA-2317(008)



Middle Creek Bridges Typical Sections

Phase 1A

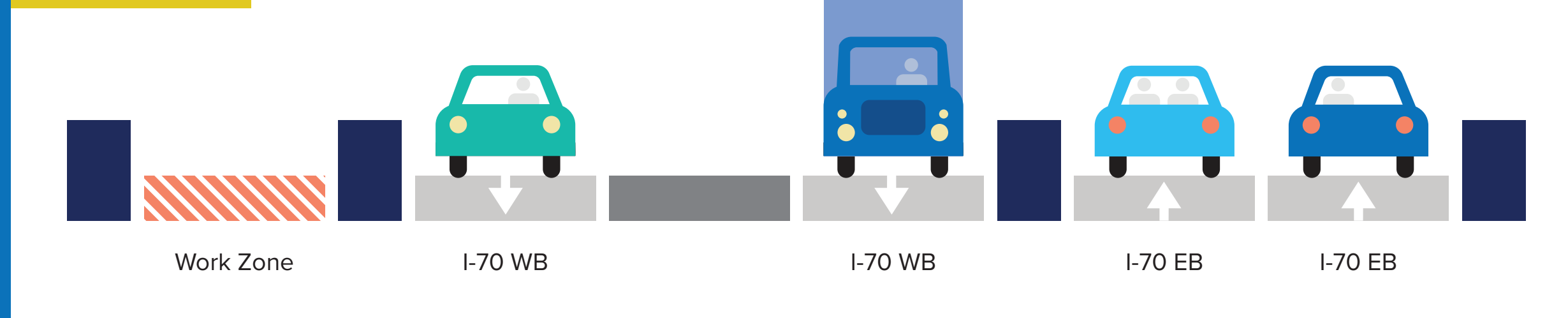

• Maintain two lanes in each direction using contra flow concept for Middle Wheeling Creek Bridge

Phase 1B

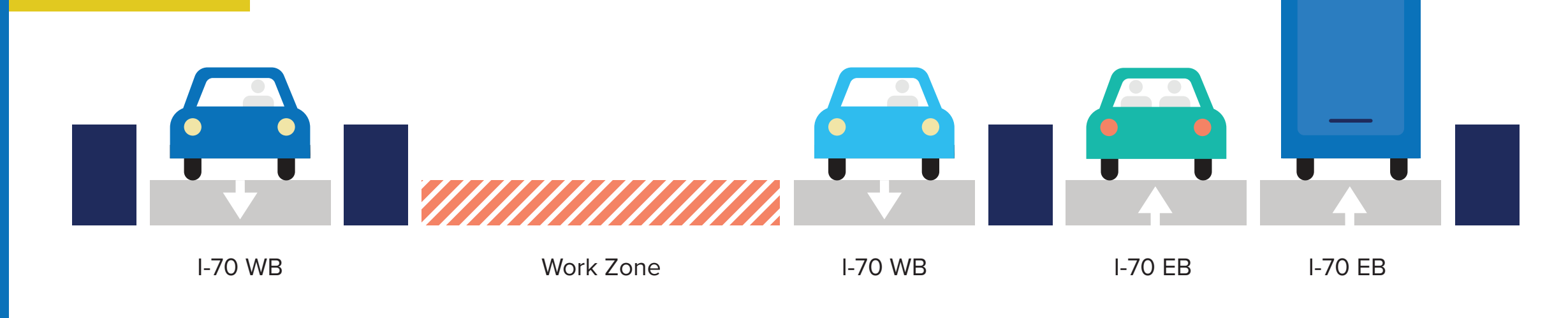

• Maintain two lanes in each direction using contra flow concept for Middle Wheeling Creek Bridge

Phase 2A

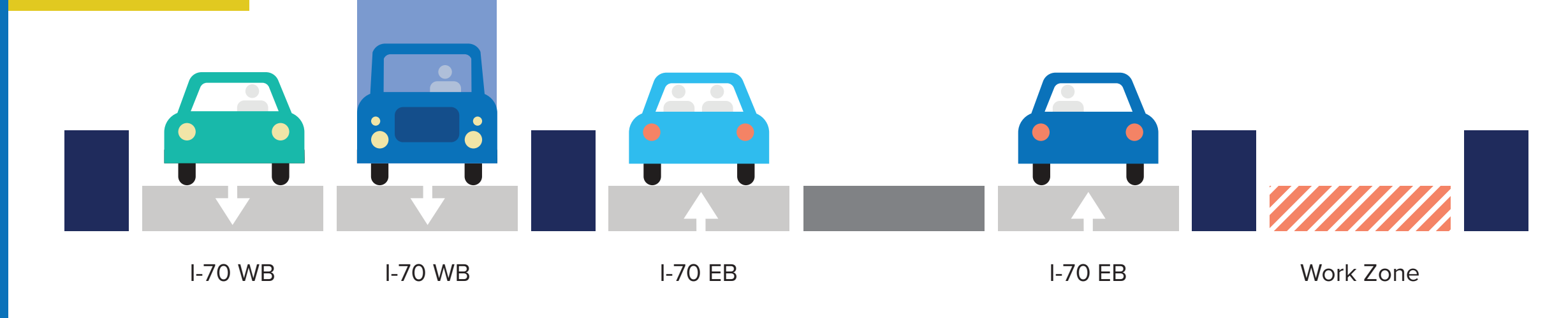

• Maintain two lanes in each direction using contra flow concept for Middle Wheeling Creek Bridge

Phase 2B

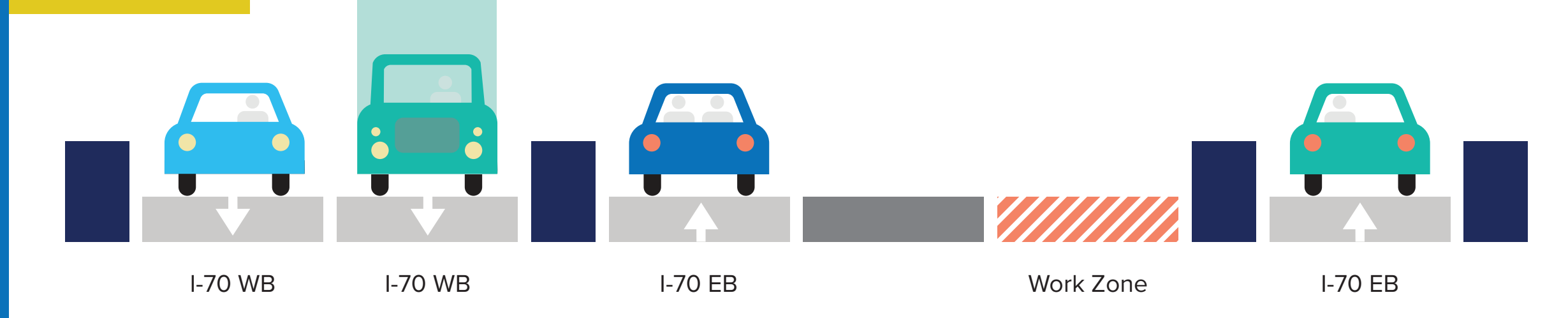



• Maintain two lanes in each direction using contra flow concept for Middle Wheeling Creek Bridge





Legend

-  Not Included in Project
-  I-70 Interstate



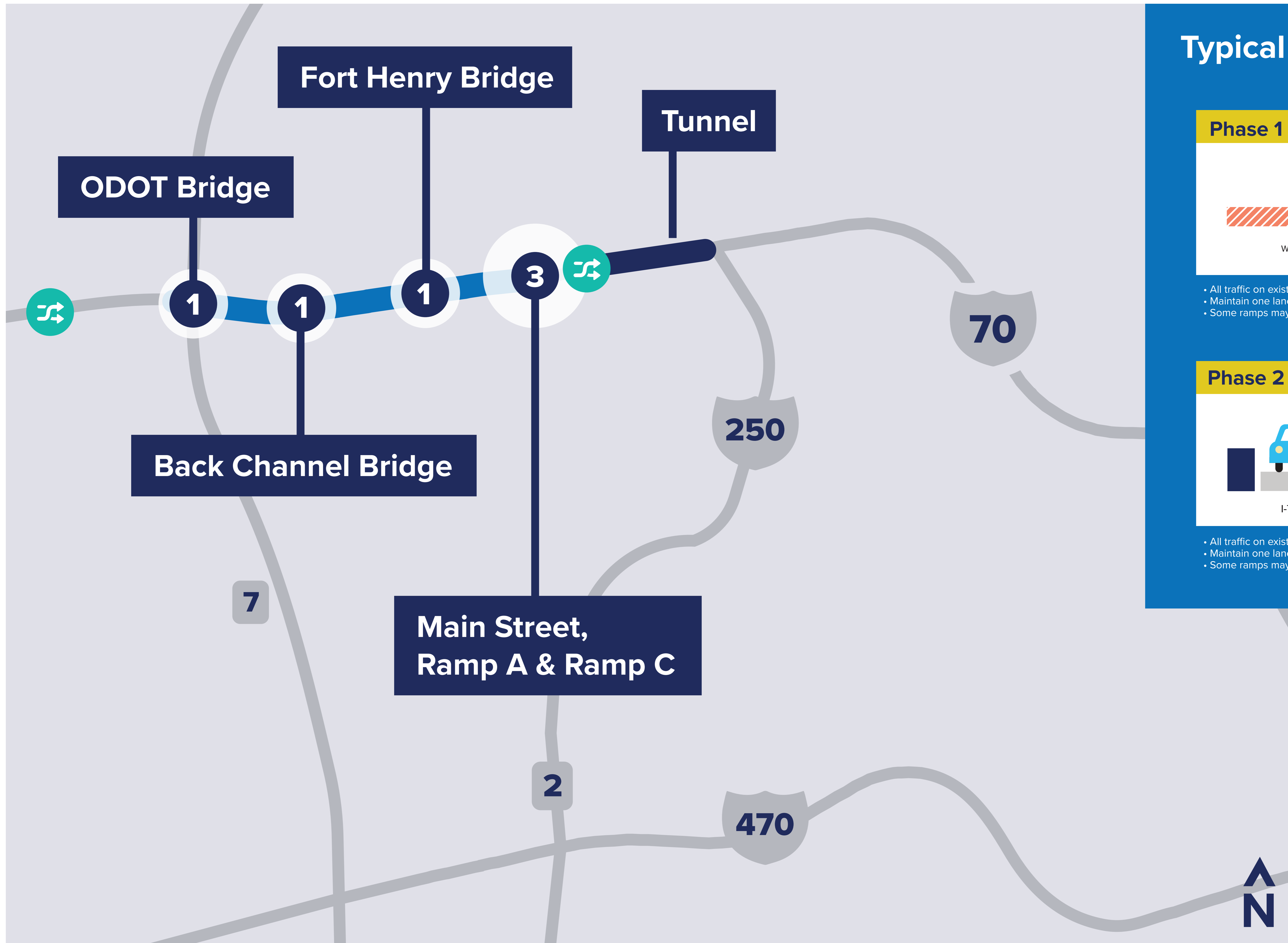

Typical Sections

Phase 1

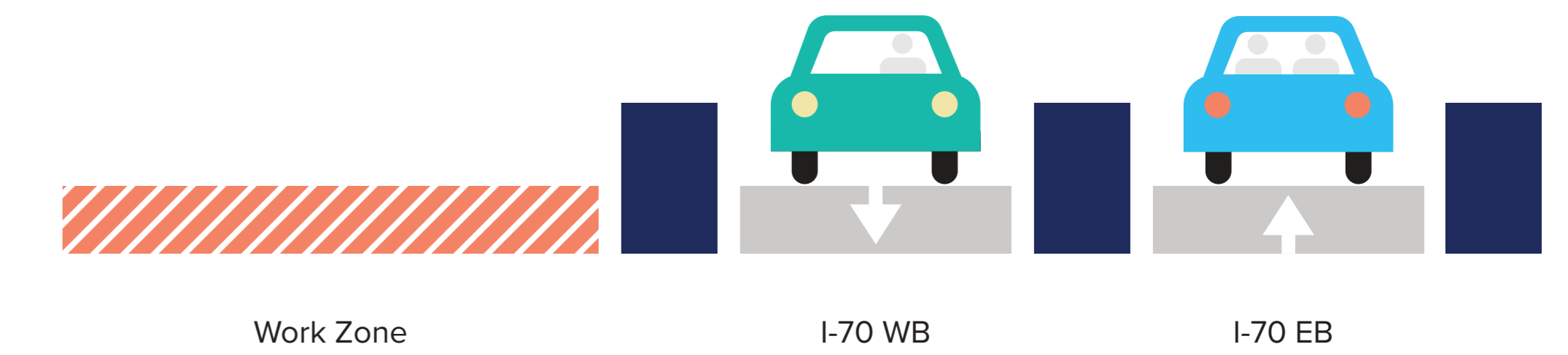

- All traffic on existing I-70 EB lanes
- Maintain one lane in each direction from ODOT Bridge to Wheeling Tunnel
- Some ramps may be closed and detoured

Phase 2

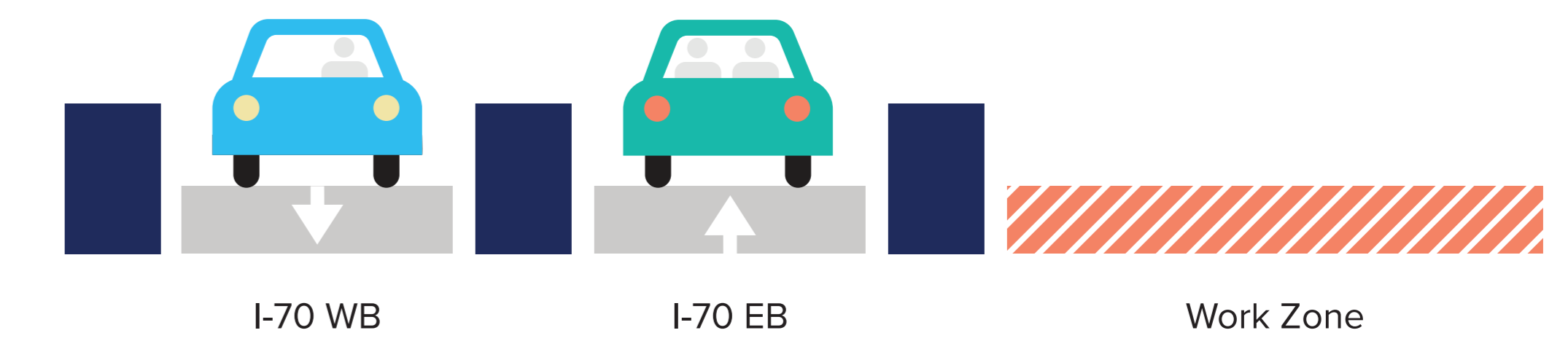

- All traffic on existing I-70 WB lanes
- Maintain one lane in each direction from ODOT Bridge to Wheeling Tunnel
- Some ramps may be closed and detoured

Legend



Crossover



Not Included in Project



I-70 Interstate

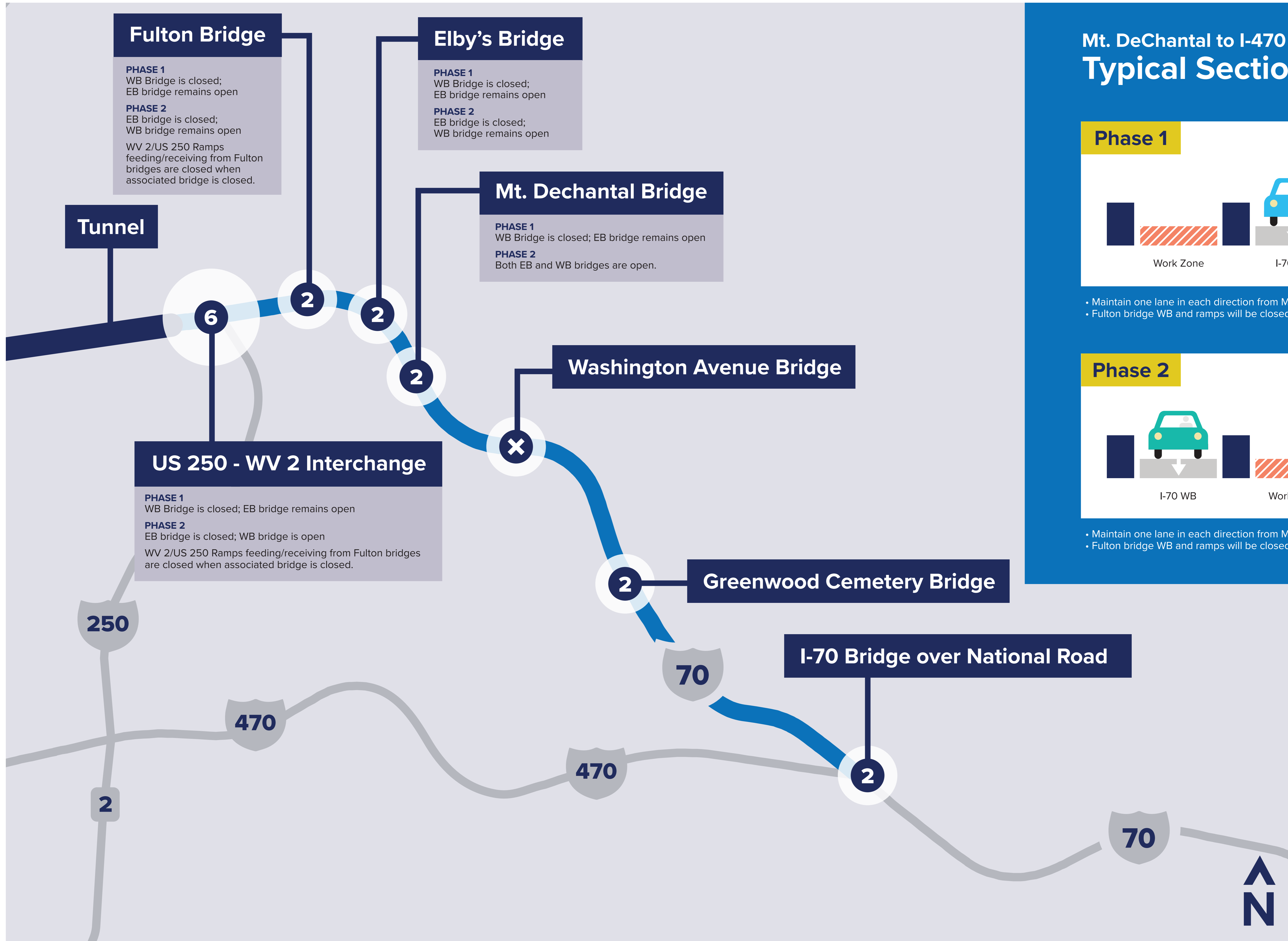

Fulton Bridge

PHASE 1
WB Bridge is closed;
EB bridge remains open

PHASE 2
EB bridge is closed;
WB bridge remains open

WV 2/US 250 Ramps
feeding/receiving from Fulton
bridges are closed when
associated bridge is closed.

Elby's Bridge

PHASE 1
WB Bridge is closed;
EB bridge remains open

PHASE 2
EB bridge is closed;
WB bridge remains open

Mt. Dechantal Bridge

PHASE 1
WB Bridge is closed; EB bridge remains open

PHASE 2
Both EB and WB bridges are open.

Washington Avenue Bridge

Greenwood Cemetery Bridge

I-70 Bridge over National Road

Tunnel

US 250 - WV 2 Interchange

PHASE 1
WB Bridge is closed; EB bridge remains open

PHASE 2
EB bridge is closed; WB bridge is open

WV 2/US 250 Ramps feeding/receiving from Fulton bridges
are closed when associated bridge is closed.

Mt. DeChantal to I-470 Typical Sections

Phase 1

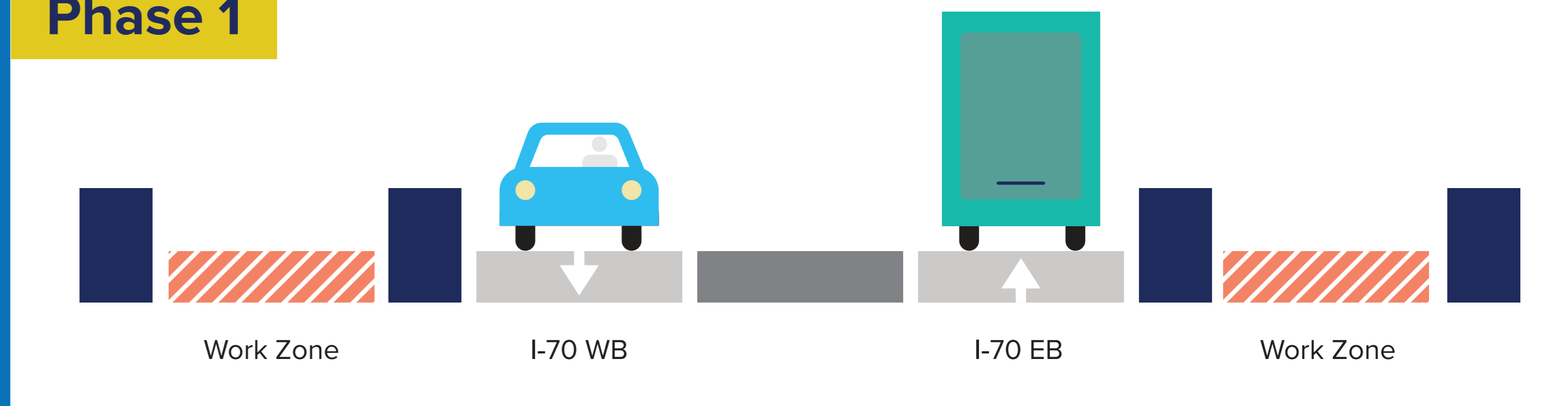

- Maintain one lane in each direction from Mt. Dechantal to I-470 split
- Fulton bridge WB and ramps will be closed

Phase 2

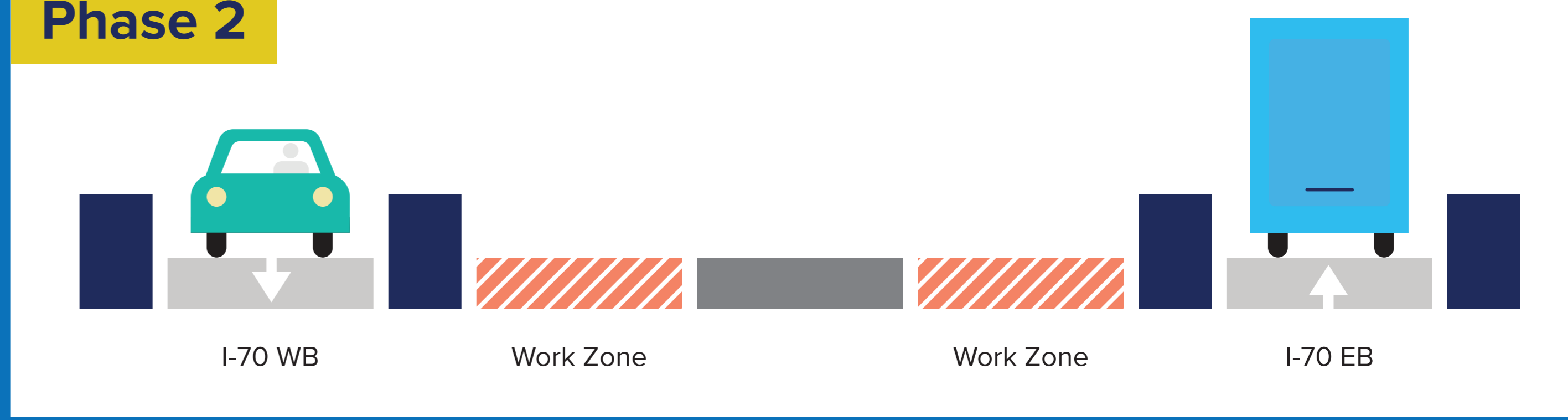

- Maintain one lane in each direction from Mt. Dechantal to I-470 split
- Fulton bridge WB and ramps will be closed

Legend



Not Included in Project



I-70 Interstate

Middle Creek Bridges Typical Sections

Phase 1A

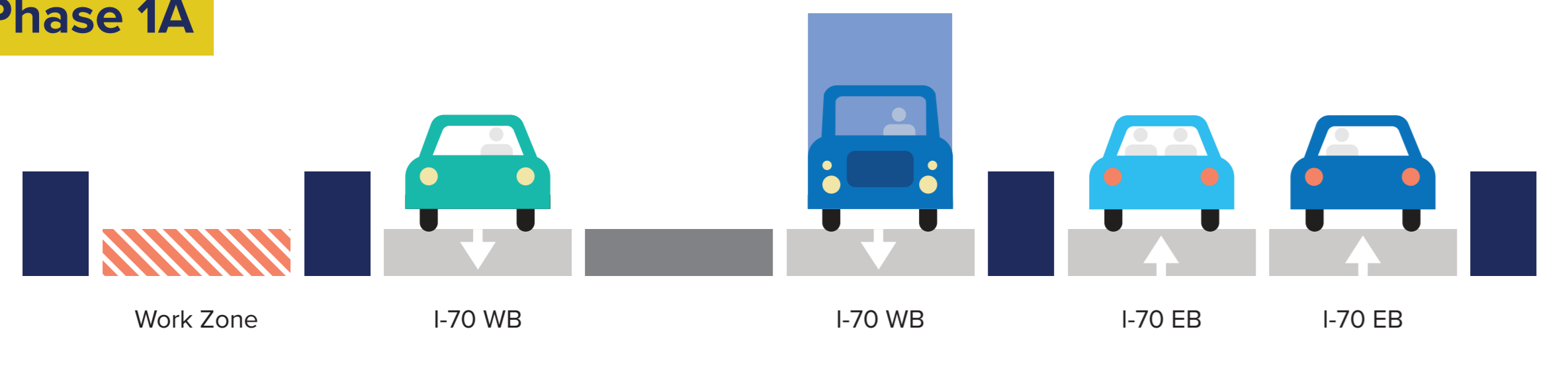

• Maintain two lanes in each direction using contra flow concept for Middle Wheeling Creek Bridge

Phase 1B

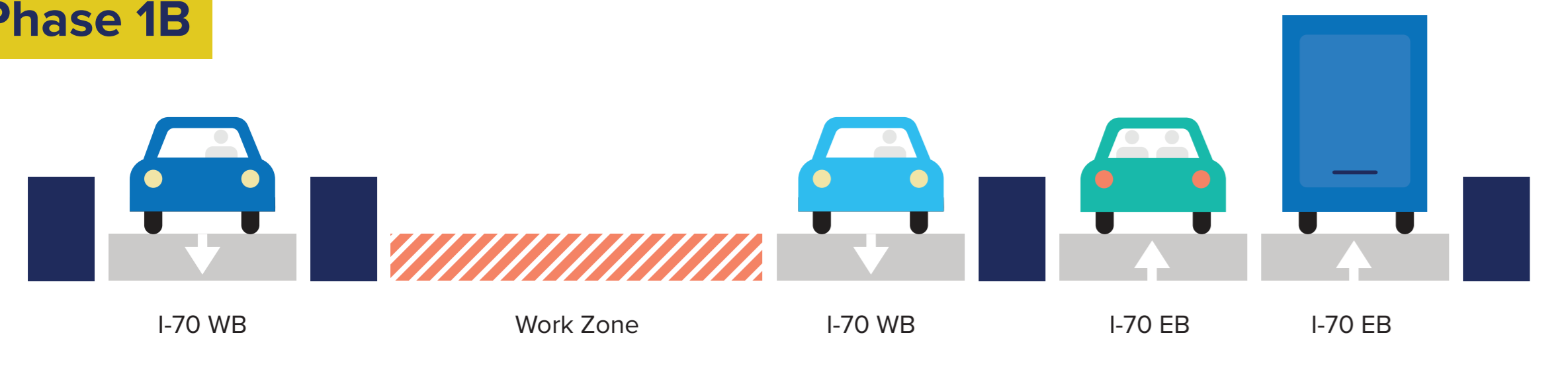

• Maintain two lanes in each direction using contra flow concept for Middle Wheeling Creek Bridge

Phase 2A

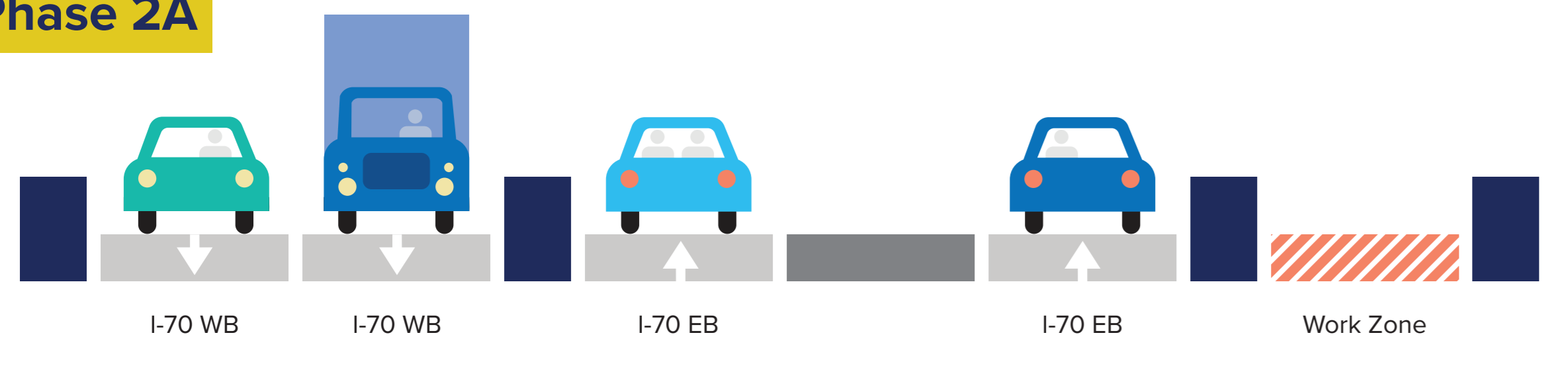

• Maintain two lanes in each direction using contra flow concept for Middle Wheeling Creek Bridge

Phase 2B

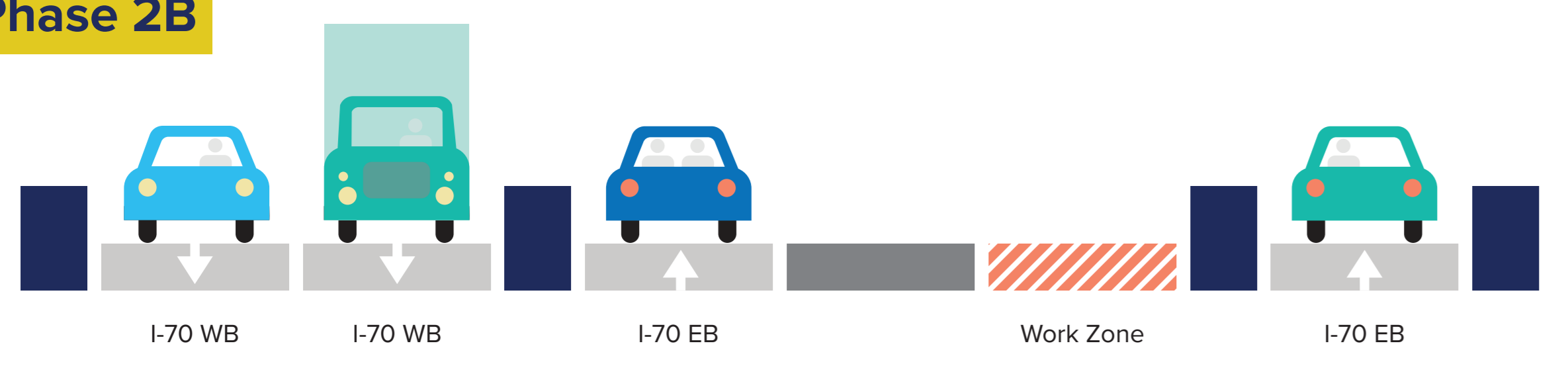

• Maintain two lanes in each direction using contra flow concept for Middle Wheeling Creek Bridge

